

SPECIFICATIONS

AIR SOCKET SWITCH ANW2440



Air Socket Switch ANW2440

Benefits/features

- Suitable for kitchen waste disposal, swimming pools, hot springs, cleaning equipment, etc
- Use as remote control device that works in conjunction with pneumatic buttons
- Only for indoor use

Basic information

Gas tightness	Under 50psi pressure, no leakage phenomenon
Pressure range	< 130mbar
Switching load	12A at 125VAC
Dielectric strength	1500V
Temperature	Ambient: -10... +50°C [14... 122°F]
Air tube	Air tube length optional
Tests / Admissions	UL 60730 (the Standard for Safety For Industrial Control Equipment)

*RoHS-compliant products are assigned separate material numbers. Please ensure careful selection when placing an order.

Dimensions in mm [in]

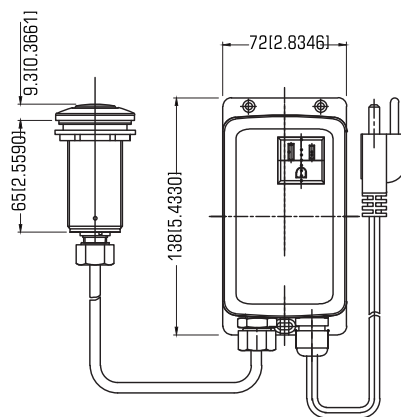
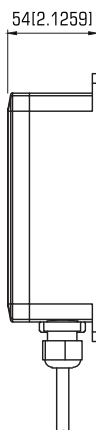
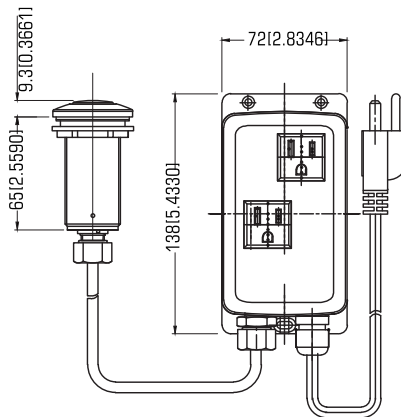
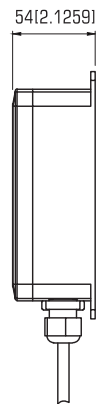

ORDER CODE SELECTION TABLE & USAGE

AIR SOCKET SWITCH ANW2440



Nickel plating



Matte black



Stainless steel mirror finish



PVD coating on brass surface

Air Socket Switch ANW2440

Name	Socket Hole	Button Type	Button
ANW2440	S	A	S

D=Double socket S=Single socket	A=M28 short button B=M32 short button C=M32 long button	N=Nickel plating B=Matte black S=Stainless steel mirror finish O=PVD coating on brass surface (Other colors can contact the factory)
------------------------------------	---	--

Usage diagram

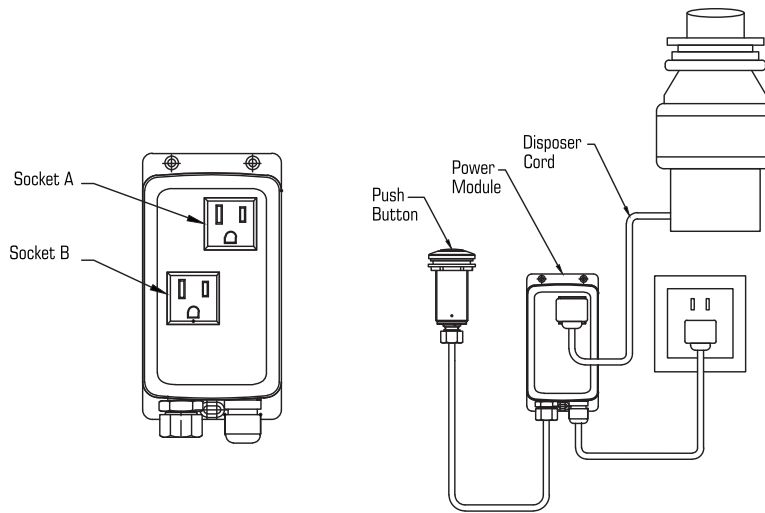

This socket comes in two different styles: one is always live, and the other is switch-controlled.