

SPECIFICATIONS

SIGHT GLASS ANWSG



Sight Glass ANWSG

Benefits/features

- High-precision color-changing indicator, wide-angle clear glass cover plate to ensure accurate identification
- Brass material welding, sturdy and corrosion-resistant, explosion-proof pressure connection for safety
- Sealing parts adopt high-performance polytetrafluoroethylene, 100% leak tested to ensure no leakage
- Ring-shaped indicator paper design, eliminating adapter sockets, low pressure loss
- Threaded and welded interfaces optional, compatible with HCFC, HFC, and corresponding lubricants

Basic information

Process connection	7/16-20UNF, 5/8-18UNF, 3/4-16UNF, 7/8-14UNF, 1-1/16-14UNF
Annual refrigerant leakage amount	≤2g R22/a

Electrical overview

Max.working pressure	4.5MPa
Max.proof pressure	6.8MPa

Operating conditions

Medium	Applicable to HCFC and HFC refrigerants: R22, R134A, R404A, R407C, R410A, R507C, etc.
Temperature	Ambient:-50...+80°C[-58...+176°F] Medium:-40...+80°C[-40...+176°F]

Installation arrangement

Mounting position	Vertical installation preferred, horizontal installation also possible; liquid pipe and gas pipe.
-------------------	---

Dimensions

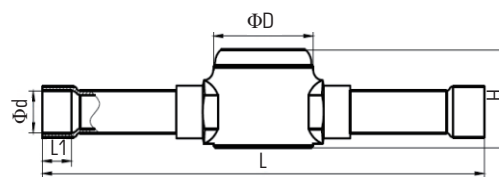

■ ODFXODF welding groove

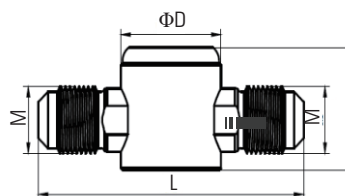

■ SAEXSAE thread opening

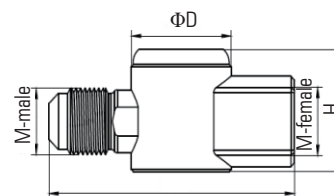

■ MaleXFemale thread opening

ORDER CODE SELECTION TABLE

SIGHT GLASS ANWSG

Sight Glass ANWSG

ANWSG	Model	Pipe Size	L(mm)	L1(mm)	H(mm)	D(mm)	d(mm)	M	Male	Female
	4	1/4"	100	7	23	26.5	6.5		--	
	4-1		64	--	23	26.5	--		7/16-20UNF	
	4-2		59	--	24.5	26.5	--			
	6	3/8"	118	8	23	26.5	10.1		--	
	6-1		70	--	23	26.5	--		5/8-18UNF	
	6-2		65	--	29	26.5	--			
	8	1/2"	144	10	28	26.5	12.8		--	
	8-1		78	--	28	26.5	--		3/4-16UNF	
	8-2		70	--	31.5	26.5	--			
	10	5/8"	150	14	31	26.5	16.1		--	
	10-1		78	--	31	26.5	--		7/8-14UNF	
	10-2		78	--	37	30	--			
	12	3/4"	166	16	34	31.5	19.1		--	
	12-1		94	--	34	31.5	--		1-1/16-14UNF	
	14	7/8"	172	17	37	31.5	22.3		--	
	18	1-1/8"	212	18	42	31.5	28.7		--	

Note:

Model naming: ANWSG-a-b, where a represents the port size and b represents the port type.

a options: 4 (1/4"), 6 (3/8"), 8 (1/2"), 10 (5/8"), 12 (3/4"), 14 (7/8"), 18 (1-1/8")

b options: None=ODFxODF, 1=SAExSAE, 2=MalexFemale

L, L1, H, D, d, M correspond to the diagram on the previous page.

Comparison table of refrigerant with water content and color

Medium	Water Content PPM(one in a million)					
	25 C (77°F)			43°C (109.4°F)		
	Green/dry	Intermediate color/warning	Yellow/moist	Green/dry	Intermediate color/warning	Yellow/moist
R22/R502	<30	30...120	>120	<50	50...200	>200
R134a	<30	30...100	>100	<45	45...170	>170
R404a	<20	20...70	>70	<25	25...100	>100
R407C	<30	30...140	>140	<60	60...225	>225
R507	<15	15...60	>60	<30	30...110	>110
R401A	<66	66...266	>266	<135	135...540	>540
R410A	<60	60...280	>280	<75	75...420	>420